

REVISIONS			
REV	DESCRIPTION	BY	DATE
1	GENERAL REVISIONS	—	—
2	GENERAL REVISIONS	—	—
3	REMOVED ROV EQUIPMENT	WDT	6-6-12
4	INSTALLED TAUT WIRE SYSTEM	MGS	3-20-13
5	ADDED 1250kw GEN SET	WDT	12-24-13
6	ADDED 1250kw GEN SET	MGS	8-20-15
7	REVISED LOCKER/MUD ROOM WITH ADDITIONAL LOCKERS. ADDED ROV TO FOC'SLE DECK AND 8-MAN UNITS TO 01 DECK	—	—
8	REMOVED AFT CRANE BLOCK PER AS-BUILT	JUG	9-29-15
9	REMOVED 2 x 8-MAN UNITS TO 01-DECK	MGS	11-3-15
10	INSTALLED ROV ON 01-DECK	MGS	3-31-16

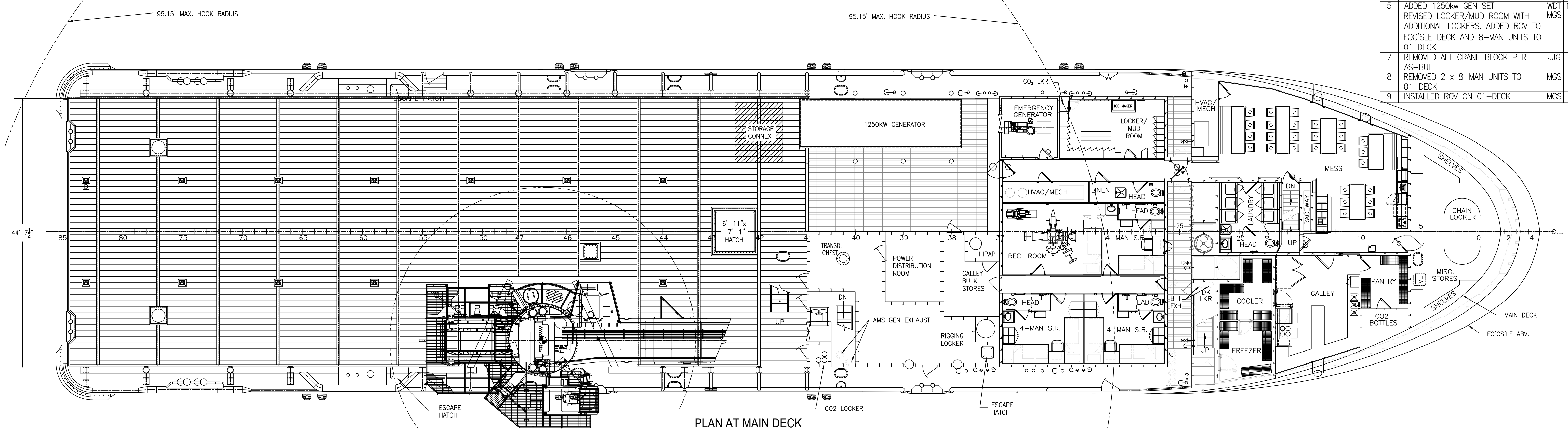

PLAN AT MAIN DECK
 @ 18'-0" ABV. BASELINE
 SCALE: 1/8" = 1'-0"

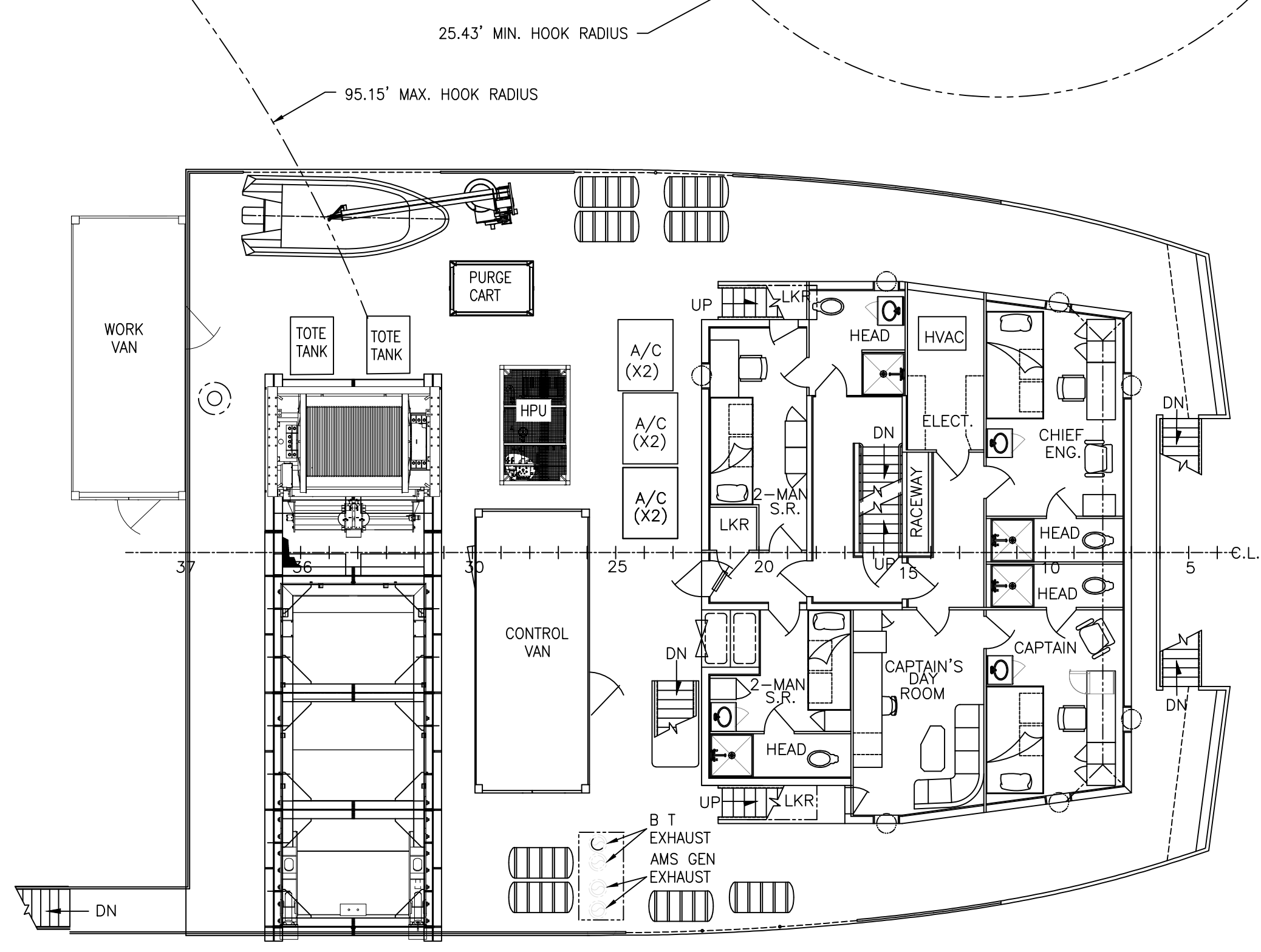

PLAN AT 01 LEVEL
 @ 37'-6" ABV. BASELINE
 SCALE: 1/8" = 1'-0"

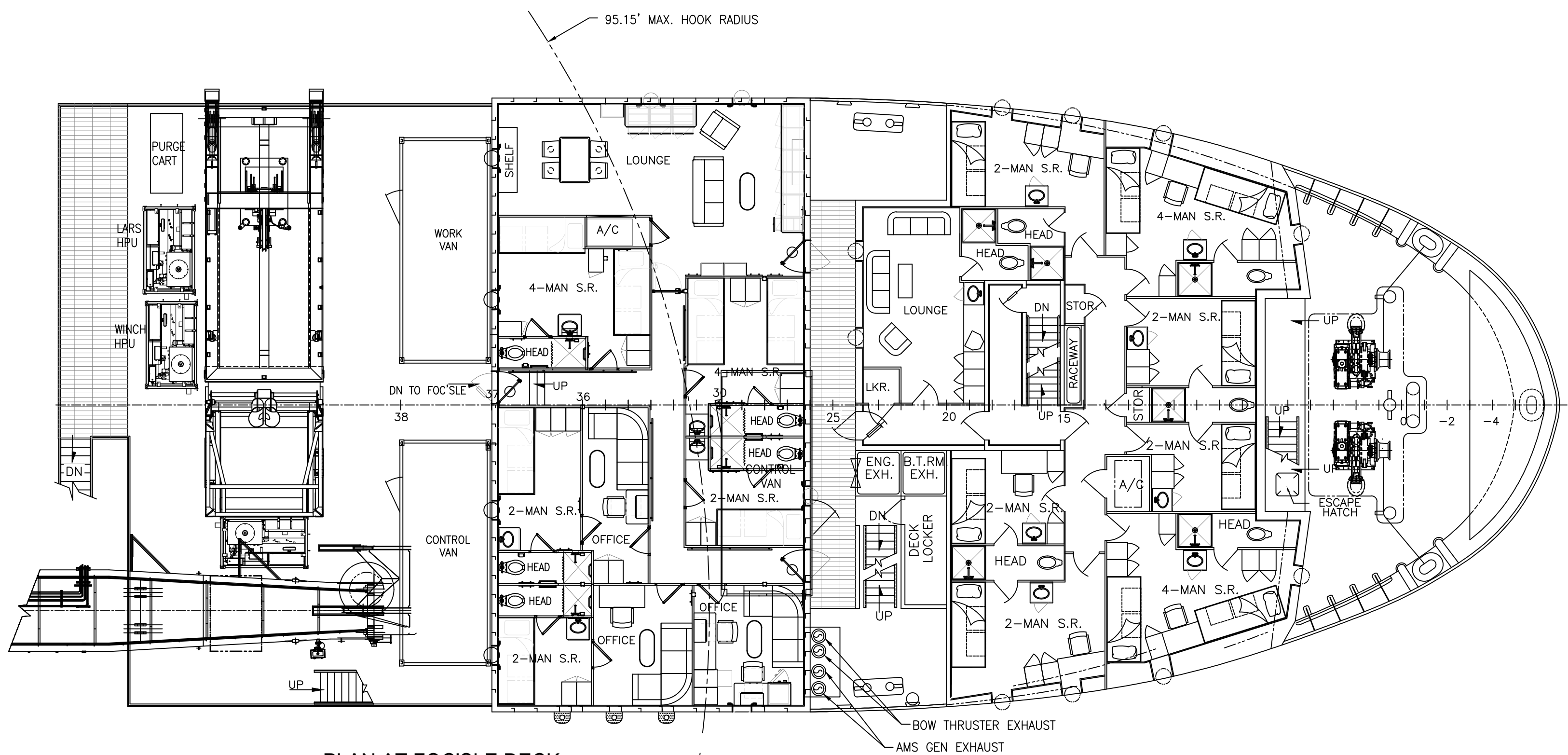

PLAN AT FOC'SLE DECK
 @ 28'-0" ABV. BASELINE
 SCALE: 1/8" = 1'-0"

THIS DRAWING, DESIGN CONCEPT AND SPECIFICATIONS ARE THE PROPERTY OF HORNBECK OFFSHORE SERVICES AND ARE FURNISHED ON A CONFIDENTIAL BASIS WITH AN EXPRESSED UNDERSTANDING THAT THEY WILL NOT BE COPIED IN ANY MANNER USED FOR MANUFACTURE, SOLD, TRANSFERRED, NOR USED TO THE EXTENT OF SAID FIRM WITHOUT WRITTEN PERMISSION.

HORNBECK OFFSHORE SERVICES

DRAWN BY:	MGS	250'-0" X 54'-0" X 19'-0"	
CHK'D. BY:	PAL	GENERAL ARRANGEMENTS	
APP'D. BY:	PAL	SCALE: 1/8" = 1'-0"	DATE: 3/23/16
TASK #	6343	DRAWING #	1.002
		HULL#	LVI-345
		SHEET	1 OF 1
		REV.	9