

PRINCIPAL PARTICULARS

LOA	251'-4" (76.6m)
BREADTH	52'-6" (16.0m)
DEPTH	22' 11-1/2" (7.0m)
DRAFT (LOADLINE)	19'-4" (5.89m)
CLEAR DECK CARGO AREA	172' X 44' (7,568 ft ²) / 52.4m X 13.4m (703.1 m ²)
CARGO DECK RATING	1,024lb/ft ² (5 MT/m ²)
MAIN PROPULSION	(2) X BERGEN C25:33L8PCD 6,866 BHP TOTAL
BOW THRUSTER	(2) X ROLLS ROYCE CPP TUNNEL 1,582 HP TOTAL
STERN THRUSTER	(2) X ROLLS ROYCE CPP TUNNEL 1,582 HP TOTAL
SHIPS SERVICE DIESEL GENERATOR	(2) X SCANIA 520 kW TOTAL
SHAFT GENERATOR FOR ELECTRIC THRUSTERS	(2) X MARELLI MOTOR 2,880 kW TOTAL

REGULATORY

OCEANS SOLAS
HDC, HLC, LOADLINE, OSR-S1, TCM, ABS, A1, AMS, FFV-1, DPS-2, ACCU, OSV, ENVIRO, UWILD

ACCOMMODATIONS

1P CREW STATEROOMS	8
2P CREW STATEROOMS	5
4P CREW STATEROOMS	3
TOTAL BERTHING:	30

REVISIONS				
REV	ZONE	DESCRIPTION	DATE	BY
0	ALL	DERIVED FROM AND SUPERCEDES SAS 133.101.001.A GENERAL ARRANGEMENT. CONVERTED TO HOS FORMAT.	03/28/22	SMM

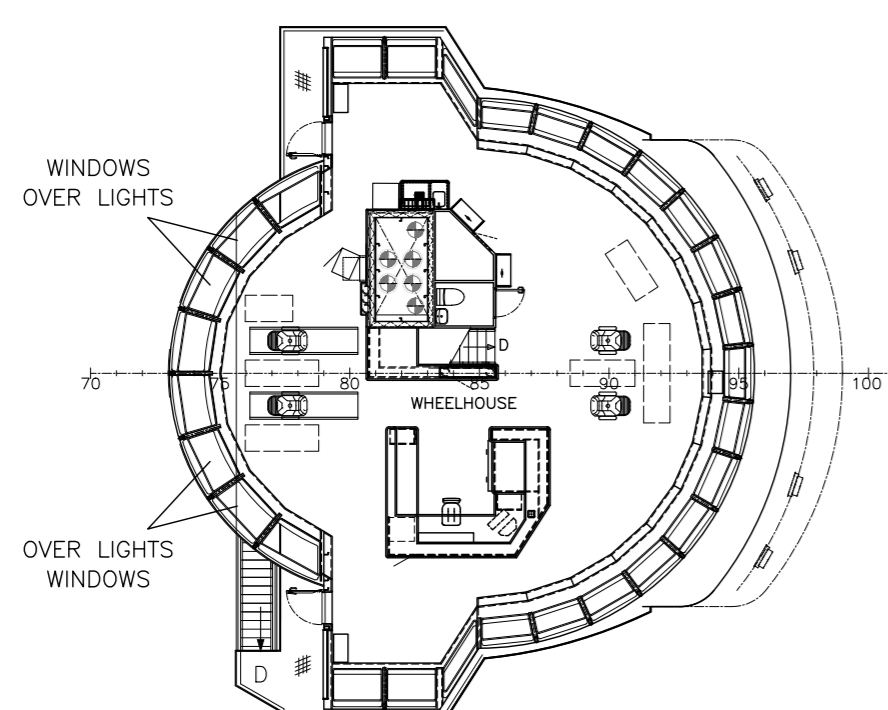
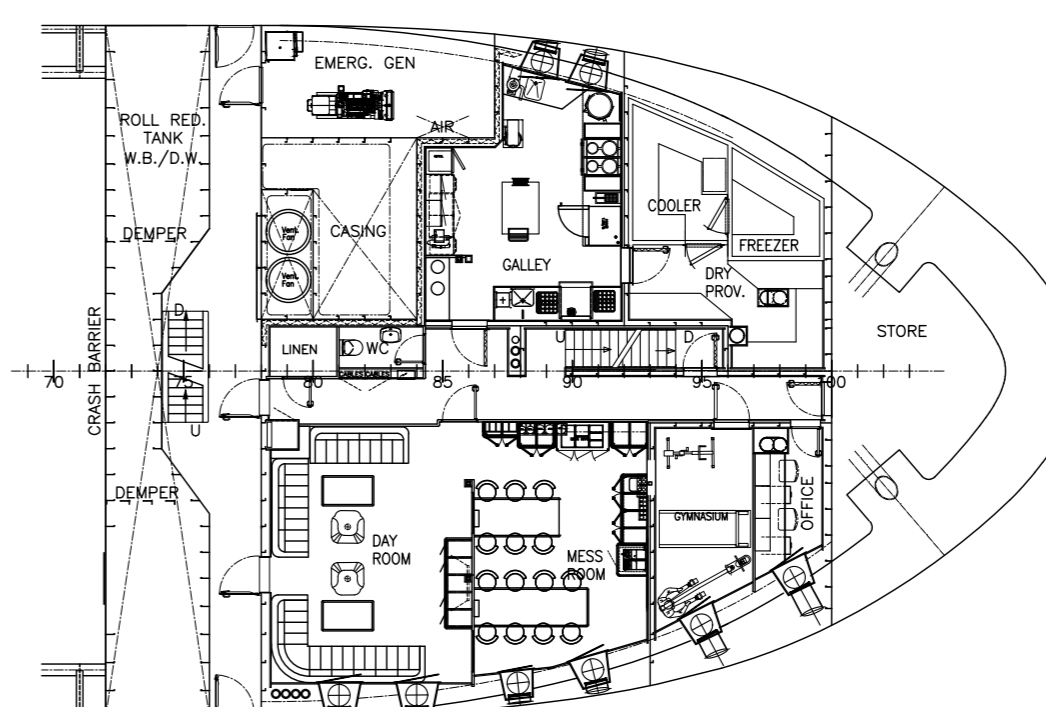
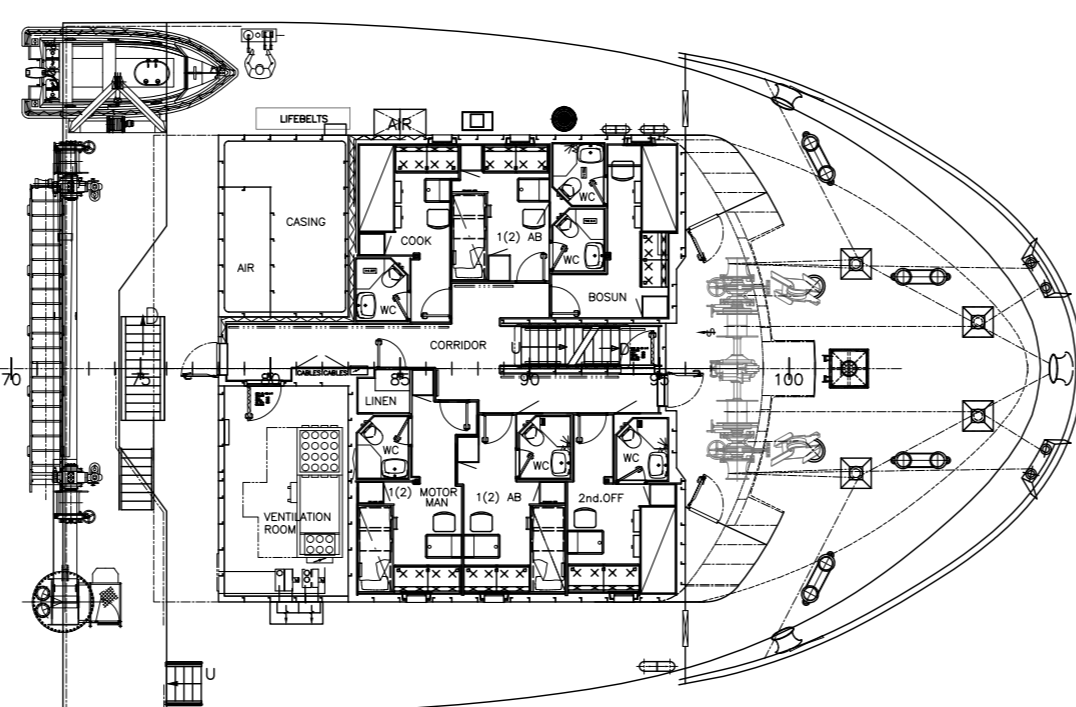
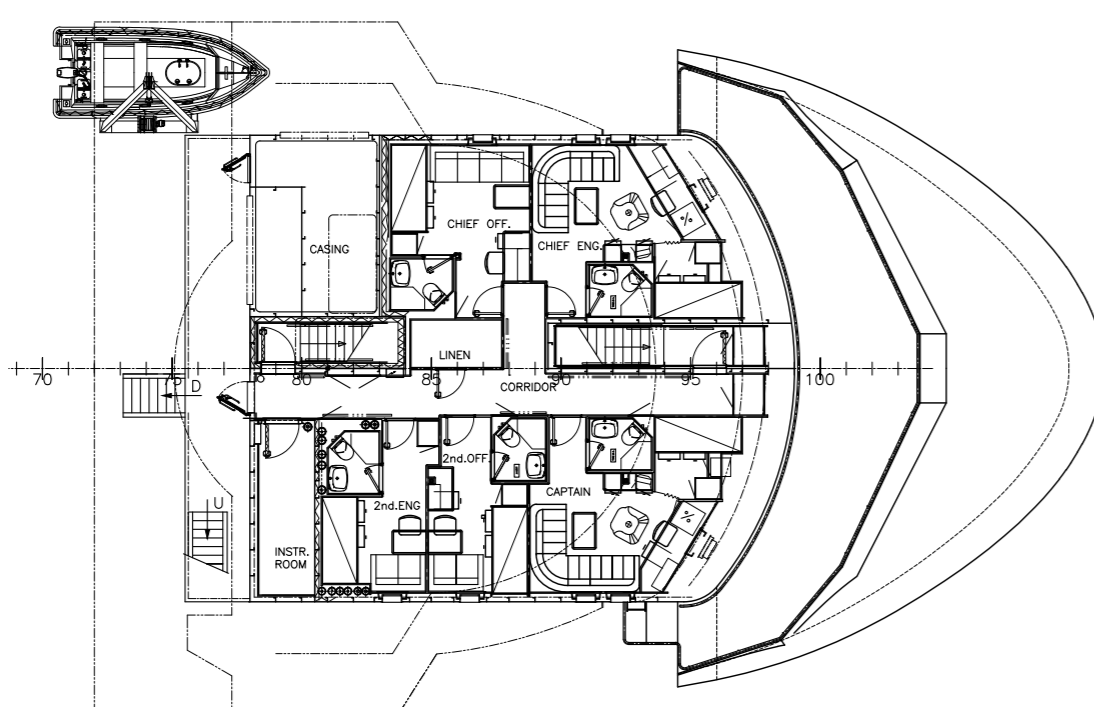
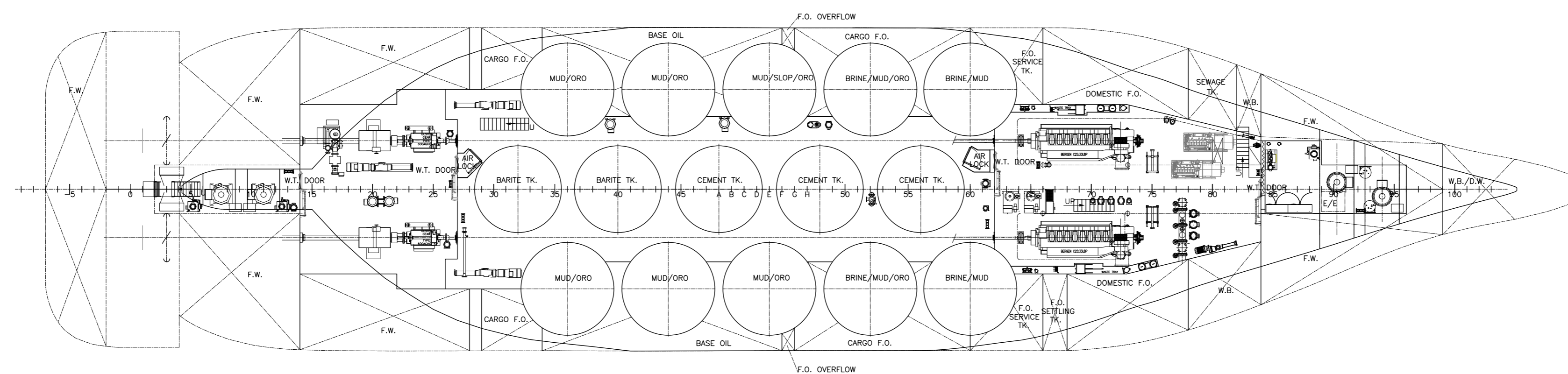
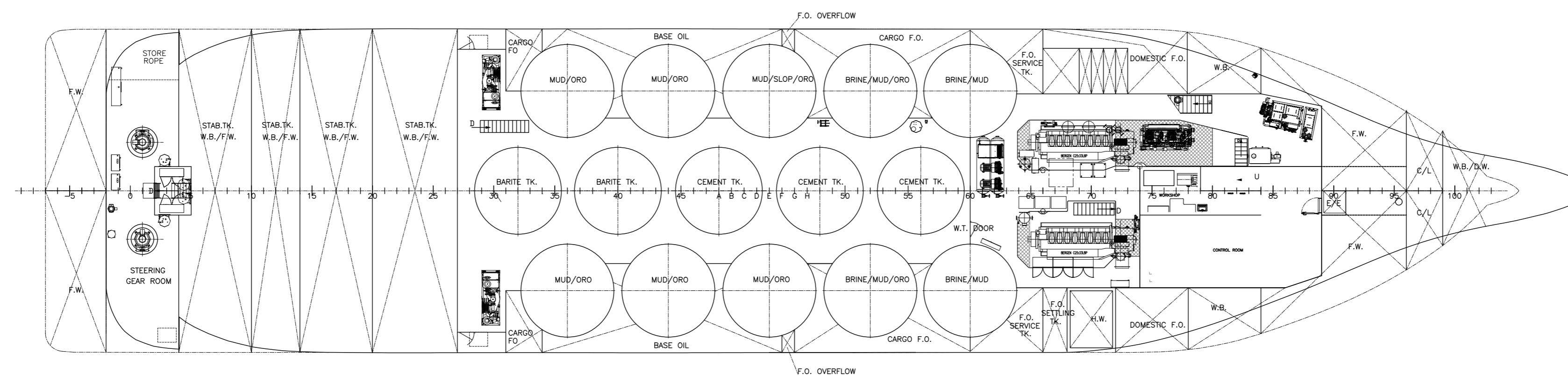
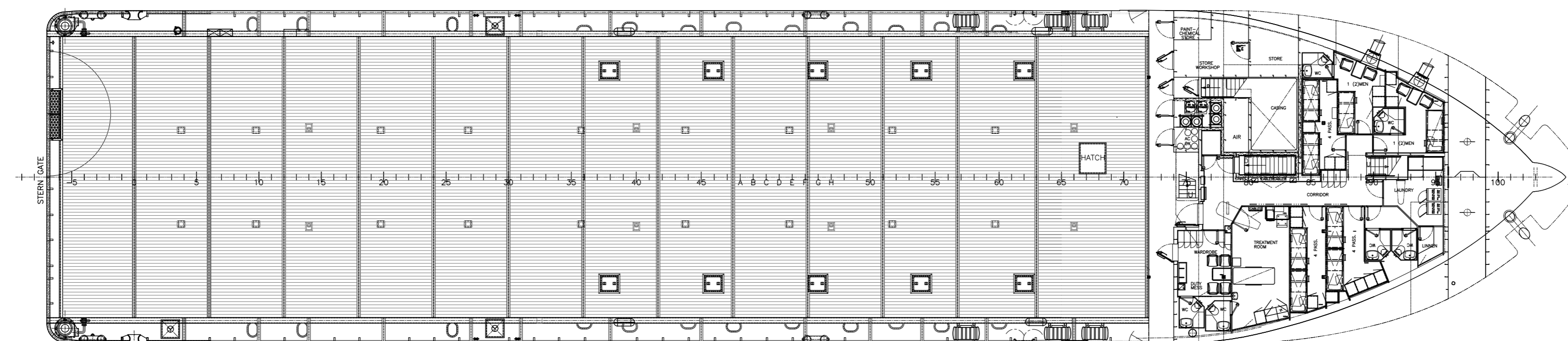
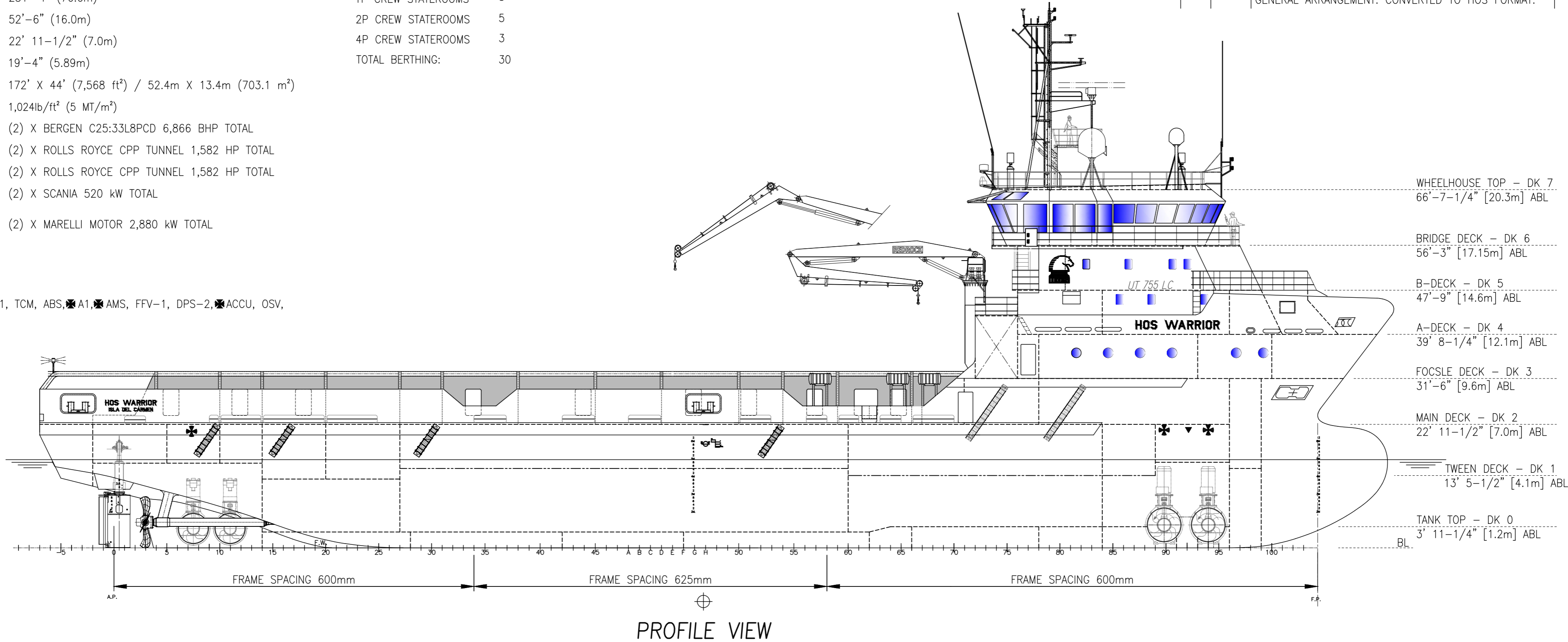

1. GENERAL ARRANGEMENT (RRM / SIMEK AS)	133.101.001.A			
NO.	TITLE	DRAWING NUMBER		
REFERENCES				
HOSMAX 240 / HOS WARRIOR				
THIS DRAWING, DESIGN CONCEPT AND SPECIFICATIONS ARE THE PROPERTY OF HORNBECK OFFSHORE SERVICES AND ARE FURNISHED ON A CONFIDENTIAL BASIS WITH AN EXPRESSED UNDERSTANDING THAT THEY WILL NOT BE COPIED IN ANY MANNER USED FOR MANUFACTURE, SOLD, TRANSFERRED, NOR USED TO THE DETRIMENT OF SAID FIRM WITHOUT WRITTEN PERMISSION. HOS ©				
HORNBECK OFFSHORE SERVICES				
DRAWN BY:	251'-4" x 52'-6" x 23'-0"			
S. MAUL				
CHECKED BY:	OUTBOARD PROFILE & GENERAL ARRANGEMENT			
M. STANSBURY				
APPROVED BY:	TASK No.	DRAWING No.	SCALE: 1:175	REV.
J. GUIDRY	7582	1.001	DATE: 03/23/22	0
	HULL No. 133	SY: SAS	SHEET 1 OF 1	